

Township N^o I North, — Range N^o III West, Humboldt Meridian.
Rec^d. with Sur. Gen's letter No 44934 of June 19th 1858.

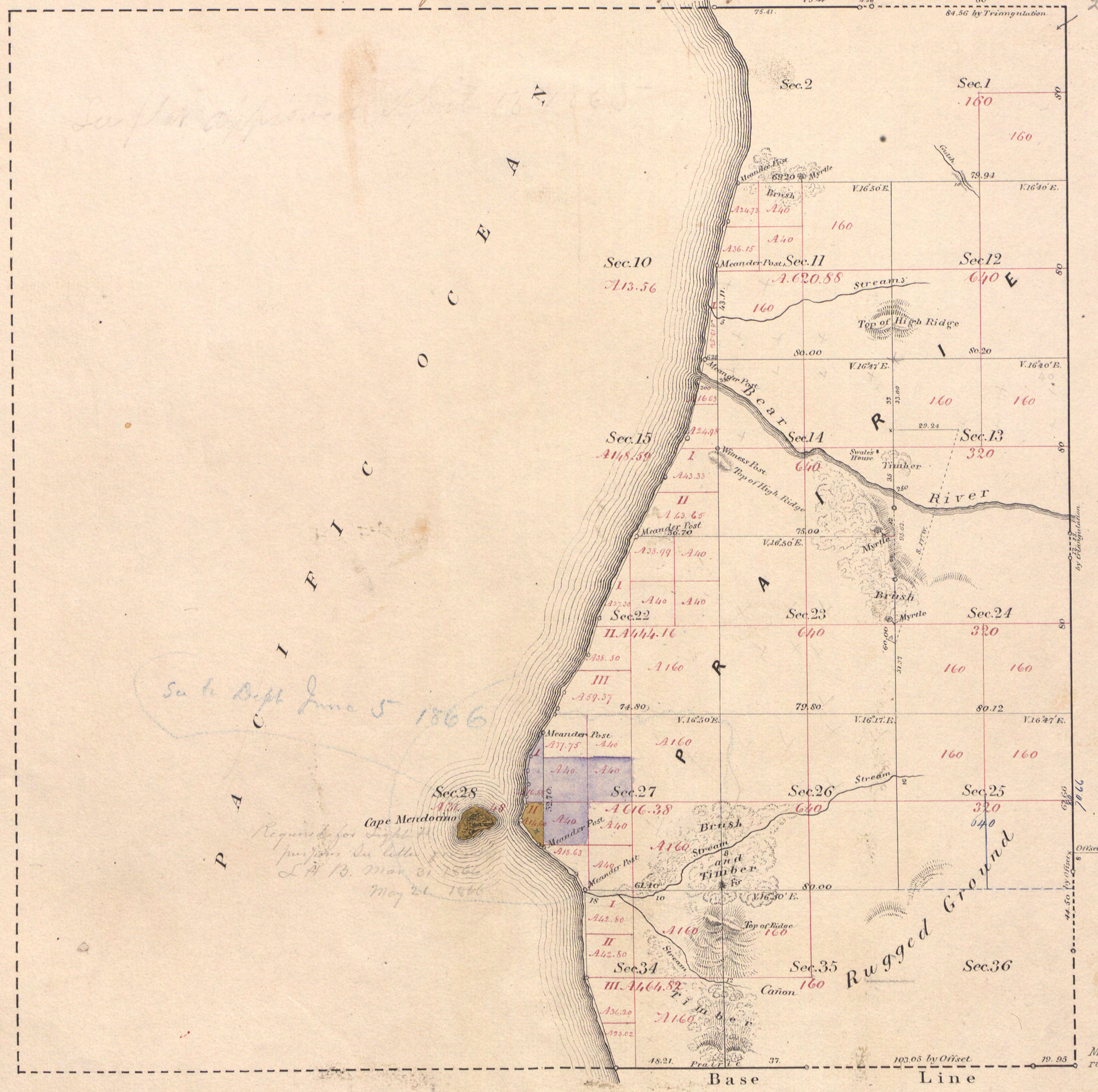

Meanders of Pacific Ocean

Section No.	Course	Distance.	Section No.	Course	Distance.
34	N. 18° W.	Ch ^s Lk ^s 42.10	27	N. 31° W.	Ch ^s Lk ^s 10.10
	North	40.00	22	N. 31° W.	2.90
27	N. 25° W.	9.00		N. 23° E.	8.00
	N. 54½° W.	18.20		N. 31° E.	20.00
28	N. 55° W.	2.85		N. 18° E.	17.00
	N. 34½° W.	14.00		N. 26° E.	41.00
	N. 21° E.	7.00	15	N. 26° E.	30.00
	North	4.00		N. 30° E.	20.00
	N. 15° E.	6.00		N. 11½° E.	36.40
	N. 6½° W.	6.00	10	N. 8½° E.	43.70
	N. 11½° E.	7.00	11	N. 15° E.	20.00
	N. 27½° E.	10.75		N. 17½° E.	18.50
	N. 31° E.	1.00			

Reserved for Light House purposes,
 by order of the President.
 June 8th 1866.
 Reserved for Light House purposes
 by order of the President May 23rd 1867

See Sur. Gen's letter
 June 28th 1867

Aggregate Area of Public Lands (Surveyed) 6179.87 Acres
 Estimated " Mountain (not Surveyed) 3112.00 "
 " " Pacific Ocean 13748.13 "
 Aggregate 23040.00 Acres

Surveys Designated.	By whom Surveyed	Date of Contract.	Amount of Survey When Surveyed
South Boundary of Township	Henry Washington	July 6 th 1853.	Miles Ch ^s Lk ^s 2.48 21 1853.
Rest of Township Lines.	John H. Miller.	April 24 th 1854	7.27 16 1854
Section Lines.	John S. Murray.	December 22 nd 1856.	19.19 25 1857.
Meander Lines	" " "	" " "	5.35 50

The above Map of Township N. 1 North, Range N. 3 West (Humboldt Meridian) is strictly conformable to the Field-notes of the Surveys thereof, on file in this Office, which have been examined and approved.
 Surveyor General's Office,
 San Francisco, California,
 May 27th 1858.

Entered
 J. W. Brantnall
 Surveyor General, California.